

Date Reviewed: 15/10/18  
 Officer initials:

## Polling place / polling station – evaluation checklist

Part A – Current polling place details	
Polling place identifier	Egleton Village Hall
Polling place name	Egleton Village Hall
Polling place address	Egleton Village Hall Egleton Oakham Rutland LE15 8AD
Number of electors (If more than one polling station within the polling place, identify split of electors)	88
Building availability for future elections/referendums	

Polling place review		
Check	√	Comment
• Are there suitable transport links?	√	Road access for villagers.
• Are there any access issues regarding main/busy roads, railways, rivers, etc.?	√	No
• Is the polling place capable of accommodating more than one polling station together with the necessary staff and equipment? If so, could it accommodate all allocated voters going in and out of the polling stations, even where there is a high turnout?	√	No – this is a small station for a small electorate and could not accommodate more than one station.
• Is the building readily available in the event of any unscheduled elections?	√	Yes.
• Is there any possibility that the building may be demolished as part of a new development?	√	No

**Identify any complaints/comments received from stakeholders at previous electoral events**

Small and compact but meets the needs of the village – recommend continue to use.  
 External paths are slippery and will require cleaning to make safe.

Date reviewed: JB

Officer initials: 16/10/2018

Part B – External areas access and facilities		
Check	(√)	Comments
• Are there good public transport links to the polling place?	√	Road.
• Is the approach to the building safe and free from obstructions and does it have a dropped kerb?	√	Yes, with slight (an inch or less) lip from road to pavement.
• Is the building clearly identifiable?	√	Yes, see pictures 1 and 2.
• Is additional signage required between street and entrance?	√	No
• Is there the facility to put up the required signage for polling day?	√	Yes
• Are there parking facilities for disabled people?	√	On-road parking outside only.
• Are there parking facilities for polling staff?	√	As above.
• Does the approach to the building have external lighting?	√	Yes
• Does the building have level access? Yes/No. If no –	√	Yes, disabled access to rear of building – Presiding Officer would need to ensure that it is clear from leaves etc.
• Has a purpose built ramp been installed?		
• If so, does it have a handrail?		
• Does the ramp have a gentle slope?		
• Does the building require a temporary ramp or is there an alternative disabled access?		
• Is the entrance door wide enough for a disabled person using a motorised wheelchair?	√	Yes, see picture 3.
• Are the doors light enough for frail/elderly voters to open?	√	Yes
• Can the 'Guidance for voters' notice be clearly displayed outside the premises, as required by the election rules?	√	Yes
• Are there any external security concerns?	√	No
• Can tellers be accommodated outside the building?	√	Yes
Key Safe mounted on left hand side of door porch – see picture 4.		

Date reviewed: JB

Officer initials: 16/10/2018

## External plan – B1

Show external layout, street name(s), car parking (including disabled car parking), ramps, steps, lighting, appropriate places for signage, etc.

Village hall is here



Date reviewed: JB

Officer initials: 16/10/2018

Aerial view – on road parking available outside station.

Station entrance here



Date reviewed: JB

Officer initials: 16/10/2018

Part C – Internal areas access and facilities		
Check	(√)	Comments
• Are all doors easy to open (including by wheelchair users) or do they need to be permanently locked back?	√	Yes
• Are there any internal steps or obstructions/hazards?	√	No, see picture 5 – access going straight in from front entrance.
• Are any doormats level with the floor?	√	Yes
• Is the floor covering non-slip (including in wet weather)?	√	Wooden floor, see pictures 6 and 7.
• Are there any corridors that may cause access problems?	√	No
• Is there adequate lighting in the corridors?	√	No
• Are there toilet facilities?	√	Yes, see picture 8.
• Is there a kitchen that staff can use?	√	Yes, see pictures 9 and 10.
• Is the area adequately lit for day and night time?	√	Yes
• Is there adequate space for signage?	√	Yes
• How many polling stations can the building accommodate?	√	One
• Does the building have a telephone available (land line) in the event of mobile network problems?	√	No. Presiding Officer requires mobile phone.

Date reviewed: JB

Officer initials: 16/10/2018

## Internal access leading to polling station(s) – C1

Show internal areas of the building, excluding the actual polling station where voting will take place, including corridors that link to the polling station, kitchen and toilets, and highlight any possible signage requirements and potential hazards. Also indicate door swing direction and ease of opening, any areas of poor lighting, and any areas of uneven floor, etc.

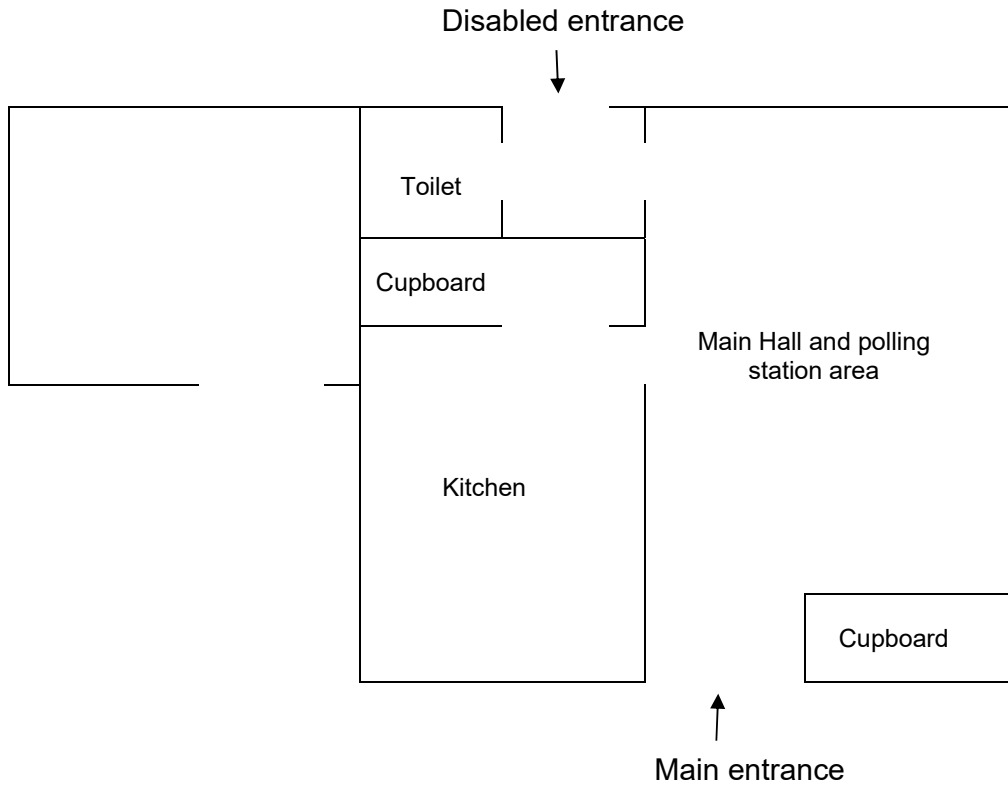

Date reviewed: JB

Officer initials: 16/10/2018

<b>Part D – The polling station(s)</b>		
<b>Check</b>	<b>(√)</b>	<b>Comments</b>
• Is there sufficient space to accommodate and manage the flow of a high volume of electors in the case of a high turnout of electors?	√	There are only 88 voters for this station which is very small but can accommodate this number.
• If multiple polling stations need to be provided, are there other rooms available, or can the space be clearly divided to provide adequate room for more than one polling station?	√	No, just one room and one station.
• Is there sufficient space inside the polling station to comfortably accommodate staff, voters, polling agents and observers?	√	Yes providing flow is constant rather than all together.
• Could ballot booths be positioned in a way that would preserve the secrecy of the ballot, even where there may be a high volume of electors?	√	Yes
• Is there adequate lighting for day and night time?	√	Yes
• Is there suitable furniture (tables and chairs) available for all types of election for polling staff and for those voters who may need to rest?	√	Yes
• Could motorised wheelchairs be accommodated?	√	Yes
• Can the official notices be clearly displayed, including the large-print version of the ballot paper(s)?	√	Yes

Date reviewed: JB

Officer initials: 16/10/2018

**Pictures:**



Picture 1 – Entrance



Picture 2 – Front of building



Picture 3 – Access for disabled



Picture 4 – key safe, left hand side of porch



Date reviewed: JB

Officer initials: 16/10/2018



Picture 5 – Entrance through to polling station



Picture 6 – polling station area



Picture 7 – polling station area



Picture 8 – toilet

Date reviewed: JB

Officer initials: 16/10/2018



Picture 9 – Kitchen facilities



Picture 10 – Kitchen facilities

Date reviewed: JB

Officer initials: 16/10/2018

Part E – Comments from stakeholders during consultation

Comment	Name/organisation	Response by (A)RO

***Additional comments from (A)RO***